

# CAMERA CONNECTION CABLE

for Mazda of 2006-2014 MY



ID: 866321

# EXAMPLES OF STANDARD DEVICES FOR WHICH CABLE IS SUITABLE



*The photo is provided for reference only. Appearance of the control panel and monitor may slightly differ depending on the car model.*

# DESCRIPTION

Cable for rear view camera connection in Mazda cars of 2006-2014 MY. Using this cable you will be able to install an aftermarket camera Plug&Play without damaging the car wires.

Image from the rear view camera will automatically be displayed on the screen when reversing. The device is connected to the 4-pin socket (as shown in the connection diagram). Depending on your car radio model, this socket may be located in a different place from the one shown in the diagram. After connection all OEM devices that work using this socket will not be disturbed and will continue to work as they did prior to the connection.

**Note!** In some cases, rear view activation signal may be absent in the wiring, connected to the head unit. For cases like this there's a gray REV wire in our cable. It should be installed, as shown in the manual. +12 V should be supplied to this wire when the car is switched to reverse (may be taken from the rear lamp). Also, you may check the connection of this activation signal in the diagnostics menu.

**Note!** The additionally installed rear view camera should be powered from ACC line (first turn of the key), otherwise the camera input will be not active. Depending on the type of the camera to be connected, namely on the voltage required for the camera, you can use input voltage +6 V, which the monitor produces. In case the camera requires more than +6 V, connect the camera power to ACC line.

# COMPATIBILITY

Model	Model years		Head unit	Screen size	Market
	From	To			
5	2008	2012	Head unit with DVD navigation	7"	US/CA/BR/JP
6 Sedan					
6 Wagon					
6 Hatchback					
CX-7	2006				
CX-9	2007				

Model	Model years		Head unit	Screen size	Market
	From	To			
2	2012	2014	NB1 with or without navigation	6.5"	US/CA/BR/JP
3					AU/EU/US/CA/BR/JP
6					
CX-5					
CX-9					

**Note!** Only NTSC cameras are supported.

# INCOMPATIBLE HEAD UNITS AND MODELS



Model	Model years		Head unit	Market
	From	To		
CX-9	2012	2014	Head unit with 4.5" color monitor	Cars for all markets
3	2011		2DIN SANYO TomTom (NVA-SD8110 model)	

# MANUALS



## CONNECTION DIAGRAM

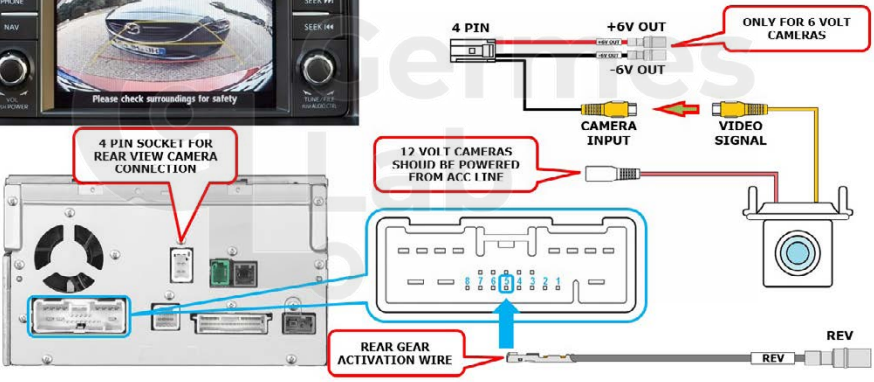



germeslab.com



Germes Lab



facebook.com/GermesLab



twittter.com/GermesLab



+852 397 33 882 (for English speaking users)

+1 323 7044 552 (for English speaking users)

+52 55 1163 8901 (para los usuarios que hablan español)

+55 61 4042 1515 (para os usuarios quem falam portugues)